



# Farmers Electric Cooperative

A Touchstone Energy® Cooperative 

301 N. Hillcrest  
Sulphur Springs, TX 75482

2000 I-30 E  
Greenville, TX 75402

108 W. Marble  
Wylie, TX 75098

Tuesday, January 29, 2019

Office of Hopkins County Judge  
PO Box 288  
Sulphur Springs TX 75483

**Farmers Electric Cooperative Member: KALLIE TANTON**  
**Service Order Number: 1901004826**

Greetings:

Farmers Electric Cooperative, Inc. is requesting permission to construct electrical power distribution facilities which will cross County Road 4762 which is located, 161 ft east of CR 4759 in Hopkins County, Texas.

Site location map and construction sketches are enclosed. The construction sketch details the proposed work. All road crossings will have a minimum vertical clearance of 22 feet.

If you have any questions, please contact me at any time.

Sincerely,

*Matthew Walker*

Project Coordinator  
mwalker@farmerselectric.coop  
Phone 903-441-1368

Submitted by Brandon Darrow  
bdarrow@farmerselectric.coop  
Field Engineering Coordinator

Enclosures

---

County Approval Section:

Approved:  Denied:

Authorized Signature: *Joe Ruiz*

Date: 1-30-19

P2 35' TO CR 4762  
& 161' TO CR 4759

EASE  
CALDWELL  
REQ'D

4 ACSR

CR 4762

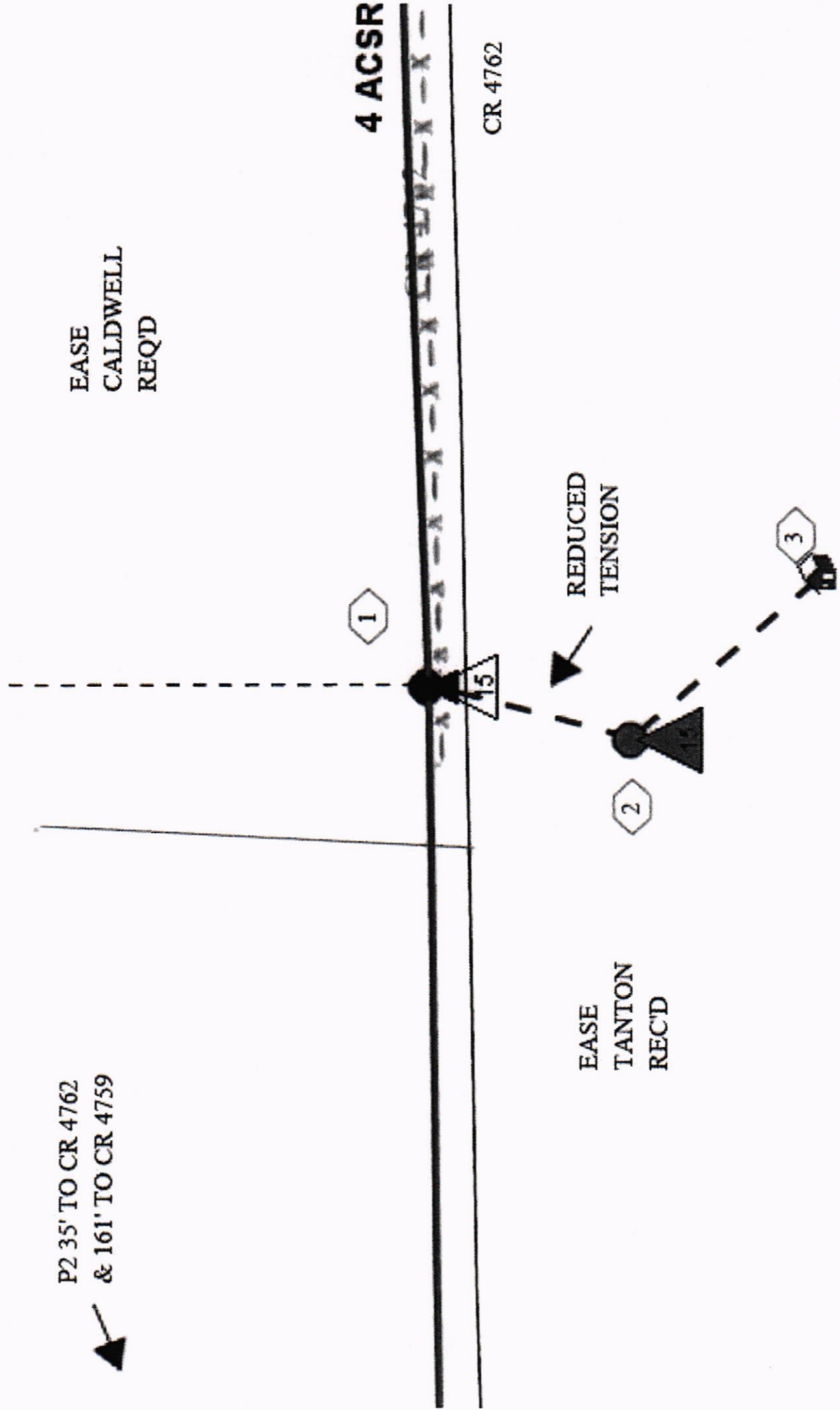

EASE  
TANTON  
REC'D

HOPKINS COUNTY PERMIT REQ'D

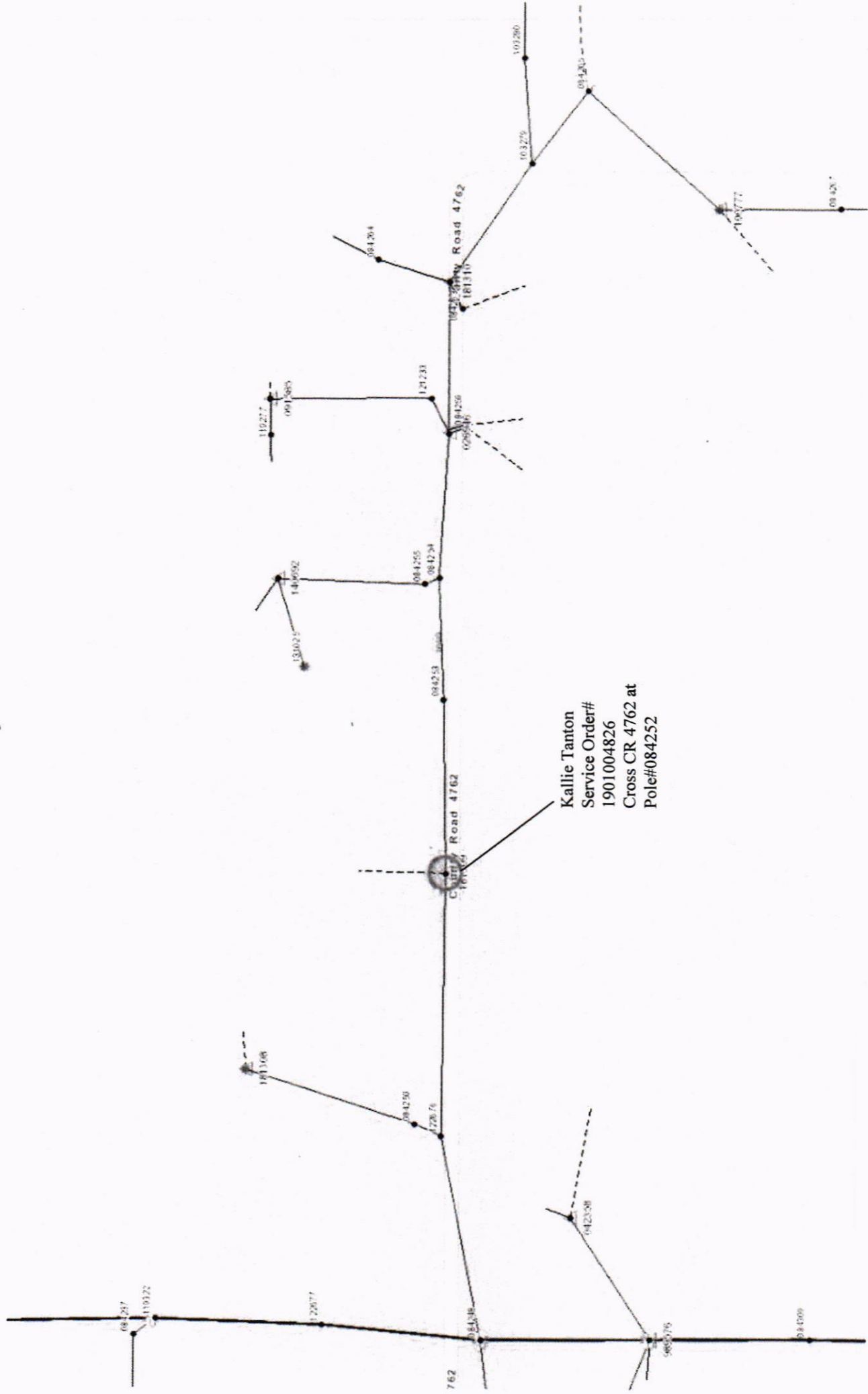

Kallie Tanton  
 Service Order#  
 1901004826  
 Cross CR 4762 at  
 Pole#084252